

Models KS / BS

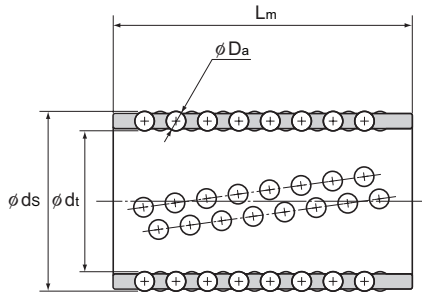

Unit: mm

Combined model No.	Main dimensions				Radial clearance tolerance μm	Basic load rating		Mass g
	d_i	D_a (inch)	d_s	L_m		C kN	C_0 kN	
KS 1955	19	3	25	55	-7	10.3	3.82	31.7
BS 1955	19	3.175 (1/8)	25.35	55	-7	11.7	4.22	33.2
KS 2260	22	3	28	60	-7	10.7	4.22	37.6
BS 2260	22	3.175 (1/8)	28.35	60	-7	12.2	4.71	39.1
KS 2565	25	3	31	65	-7	11.7	5	45.4
BS 2565	25	3.175 (1/8)	31.35	65	-7	13.2	5.59	47.1
KS 2870	28	4	36	70	-9	18	7.65	80.4
BS 2870	28	3.969 (5/32)	35.938	70	-9	17.7	7.55	80.0
KS 3275	32	4	40	75	-9	19.7	9.12	96.5
BS 3275	32	3.969 (5/32)	39.938	75	-9	19.3	8.92	96.0
KS 3880	38	5	48	80	-10	25	12	156
BS 3880	38	4.762 (3/16)	47.525	80	-10	22.5	10.9	150

Note) The outer surface of model BS has a groove to help distinguish it from KS.
Shafts for models KS and BS are also manufactured. Contact THK for details.

Model MST

dammy

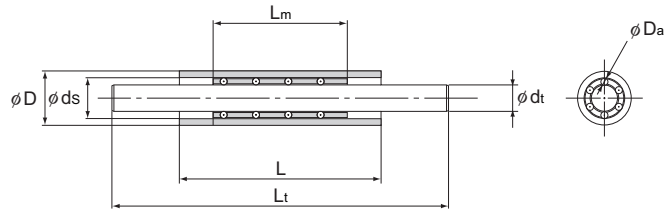

Unit: mm

Combined model No.	Ball cage					Nut					ST shaft				Combined radial clearance μm
	Model No.	Da	Lm (A)	Permissible load Co N	Mass g	Model No.	D	ds	L (B)	Mass g	Model No.	dt	Lt (C)	Mass g	
MST 3-A·B·C	M3510	1	10	68.6	0.7	S5710	7 _{-0.006} ⁰	5 ±0.002	10	1.4	T350	3 _{-0.003} ⁰	50	2.8	-2 to +5
	M3515		15	98	1.1	S5720			20	2.9	T360		60	3.3	
	M3520		20	137	1.4	S5730			30	4.5					
MST 4-A·B·C	M4610	1	10	78.4	0.9	S6810	8 _{-0.006} ⁰	6 ±0.002	10	1.7	T450	4 _{-0.003} ⁰	50	4.5	-2 to +5
	M4615		15	118	1.4	S6820			20	3.6	T460		60	5.6	
	M4620		20	157	1.9	S6830			30	5.0					
MST 5-A·B·C	M5710	1	10	98	1.1	S71010	10 _{-0.006} ⁰	7 ±0.002	10	2.9	T550	5 _{-0.003} ⁰	50	7.1	-2 to +5
	M5715		15	137	1.7	S71020			20	6.3	T580		80	12.6	
	M5720		20	186	2.3	S71030			30	10.0					
MST 6-A·B·C	M6810	1	10	108	1.2	S81120	11 _{-0.011} ⁰	8 ±0.002	20	7.1	T650	6 _{-0.003} ⁰	50	10.0	-2 to +5
	M6815		15	157	2.0	S81130			30	10.0	T680		80	16.6	
	M6820		20	216	2.6	S81140			40	12.6					

Note) If the radial clearance needs to be zero or below, add symbol "C1" at the end of the model number.

(Example) MST5-203080 C1

Combined radial clearance
Symbol for zero or below

Combination of models M5720, S71030 and T580.

Model number coding

MST 4-10 20 60 M

ST shaft outer diameter dimension (mm)

Ball cage length (mm) (A)

Nut length (mm) (B)

Using stainless steel

ST shaft length (mm) (C)

Combined model number
(ball cage): M4610 (nut): S6820 (ST shaft): T460 Combination of these components

Note) The model numbers of ball cage, nut and ST shaft are indicated in the corresponding specification table.

LM Stroke

Models ST / ST-B

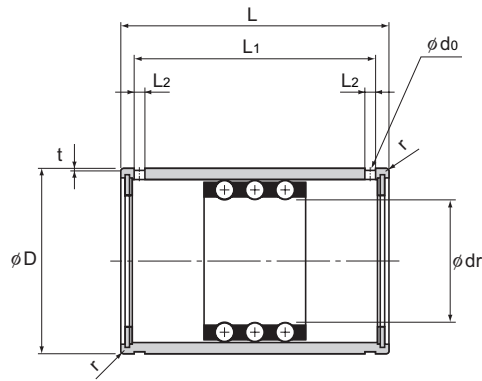

Model ST
(For light load)

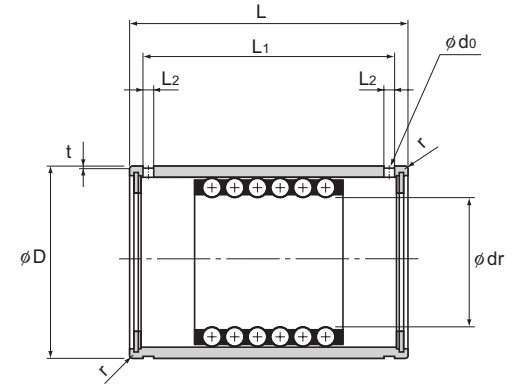

Model ST-B
(For medium load)

Unit: mm

Model No.	Maximum stroke											Basic dynamic load rating C kN	Basic static load rating C ₀ kN	Mass g	
		Inscribed bore diameter		Outer diameter		Length		L ₁	L ₂	t	d ₀				r
		dr	Tolerance	D	Tolerance	L	Tolerance								
ST 6	14	6	+0.018 +0.010	12	0 -0.008	19	0 -0.2	13.5	1.1	0.25	—	0.3	0.98	0.23	8
ST 8 ST 8B	24 8	8	+0.022 +0.013	15		24		20.1	1.5	0.5	1.5	0.5	0.98 2.06	0.27 0.55	16.4 17.6
ST 10 ST 10B	30 8	10		19	30	25.7		1.5	0.5	1.5	0.5	2.35 4.61	0.62 1.27	31.5 34.5	
ST 12 ST 12B	32 8	12	+0.027 +0.016	23	32	27.5		1.5	0.5	1.5	0.5	4.02 8.14	1.08 2.25	47 53.5	
ST 16 ST 16B	40 16	16		28	37	32.1		1.5	0.5	1.5	0.5	4.02 8.04	1.27 2.65	77 85	
ST 20 ST 20B	54 28	20	+0.033 +0.020	32	0 -0.011	45		0 -0.3	39.8	2	0.5	2	0.5	4.12 8.33	1.57 3.24
ST 25 ST 25B	54 28	25		37		45	39.8		2	0.5	2	1	4.12 8.14	1.76 3.63	128 142
ST 30 ST 30B	82 44	30		45		65	58.5		2.5	0.5	2.5	1	9.31 18.7	4.12 8.14	240 275
ST 35 ST 35B	92 54	35	+0.041 +0.025	52	0 -0.013	70	63.5		2.5	0.7	2.5	1.5	9.41 18.7	4.51 9.02	370 410

LM Stroke

Models ST / ST-B

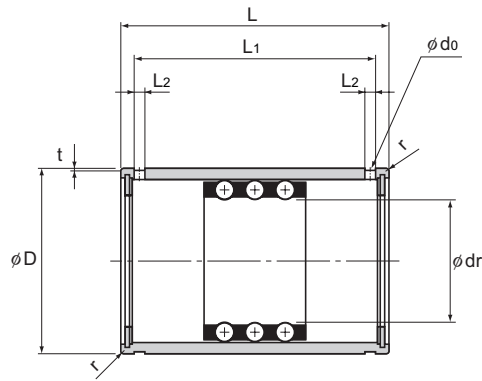

Model ST
(For light load)

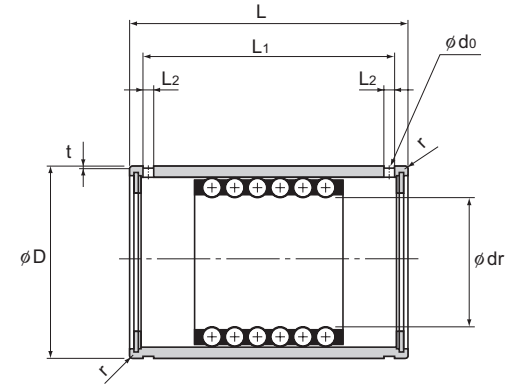

Model ST-B
(For medium load)

Unit: mm

Model No.	Maximum stroke											Basic dynamic load rating C kN	Basic static load rating C ₀ kN	Mass g	
		Inscribed bore diameter		Outer diameter		Length		L ₁	L ₂	t	d ₀				r
		dr	Tolerance	D	Tolerance	L	Tolerance								
ST 40 ST 40B	108 66	40	+0.041 +0.025	60	0 -0.013	80	0 -0.3	73.3	2.5	0.7	2.5	1.5	12.5 25	6.18 12.4	570 635
ST 45 ST 45B	108 66	45		65		80		73.3	2.5	0.7	2.5	1.5	12.6 25.2	6.76 13.5	625 695
ST 50 ST 50B	138 88	50		72		100		92.4	3	1	3	1.5	16.3 32.5	8.82 17.7	910 1020
ST 55 ST 55B	138 88	55	+0.049 +0.030	80	0 -0.015	100	0 -0.4	92.4	3	1	3	2	16.6 33	9.71 19.3	1270 1380
ST 60 ST 60B	138 88	60		85		100		92.4	3	1	3	2	16.8 33.6	10.5 21	1360 1480
ST 70 ST 70B	138 88	70		95		100		92.4	3	1	3	2	16.9 33.8	11.7 23.3	1530 1670
ST 80 ST 80B	132 76	80	+0.058 +0.036	110	0 -0.018	100	0 -0.4	92	3	1.5	3	2	21.3 42.5	15.3 30.6	2220 2430
ST 90 ST 90B	132 76	90		120		100		92	3	1.5	3	2	21.7 43.3	16.9 33.7	2440 2670
ST 100 ST 100B	132 76	100		130		100		92	3	1.5	3	2	22 43.9	18.3 36.8	2670 2910

LM Stroke